

Description : Alkaline High Voltage Battery

Nominal Voltage : 6Volts

Nominal Dimensions : Ø10.22mm×16.5mm

Terminal : Nickel plated flat contacts - protruded
red(+); recessed black (-)

Jacket : Metal jacket

Internal Connection : Pressure

Applications : Remote controller

Average Weight : 4.0g

Date Code : Unless otherwise specified, each
batteries will carry a numeric year
code and analogue month code

Shelf Life : Not less than 90% of the service
capacity within first year. , not less
than 85% of the service capacity with
third year storage at $22 \pm 3 \text{ }^\circ\text{C}$
40-80 %RH

Insulation : 5MΩ min.

Resistance

Close Circuit Voltage : 4.7 Volts (min.)(load resistor 200Ω
at $22 \pm 3 \text{ }^\circ\text{C}$ for 0.1 to 2 seconds)

Current Drain : Under 15mA pulse, 0.5mA
continuous

Nominal Service Life : 74hrs (at 10kΩ load)
(to 3.0V at $22 \pm 3 \text{ }^\circ\text{C}$)

Average Service Capacity : 38mAh(at 10kΩ load)
(to 3.0V at $22 \pm 3 \text{ }^\circ\text{C}$)

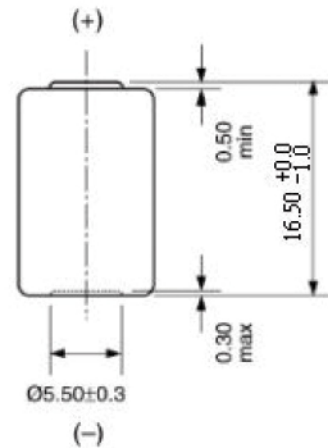
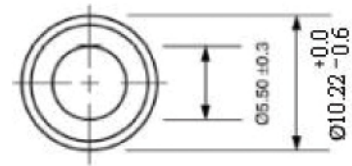

Unit : mm

Typical Discharge characteristics at $22 \pm 3 \text{ }^\circ\text{C}$

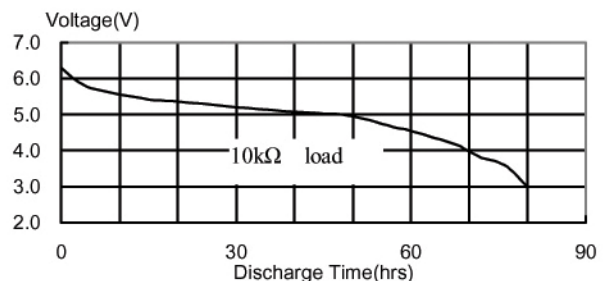

No publication or circulation of data to third parties without consent of VARTA Consumer Batteries