

## Type : D-2/3AA400

### Specifications

Nominal voltage		1.2V	
Capacity <sup>1</sup>		0.2C Discharge	1C Discharge
	Minimum	400mAh <sup>2</sup>	320mAh
	Typical <sup>3</sup>	440mAh	400mAh
Dimensions	Diameter	mm	inch
		14.5 <sup>0</sup> <sub>-0.5</sub>	0.571 <sup>0</sup> <sub>-0.02</sub>
	Height	29.0 <sup>0</sup> <sub>-1.0</sub>	1.142 <sup>0</sup> <sub>-0.039</sub>
Weight <sup>4</sup>	Grams		Ounces
	14		0.49
Internal impedance <sup>4</sup> at 1000Hz		35mΩ (After Charge)	
Charge	Standard	40mA(0.1C)X15hrs	
	Rapid	400mA(1C)X1.2hrs	
Ambient temperature	Charge		°C
		Standard	0°C to 45°C
	Rapid	10°C to 40°C	32°F to 113°F
	Discharge	-20°C to 65°C	50°F to 104°F
	Storage	-20°C to 45°C	-4°F to 149°F

### Dimensions(with tube)

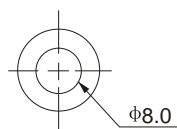
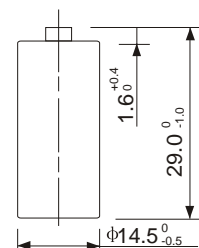

(mm)

### Typical Characteristics

#### Rapid Charge characteristics

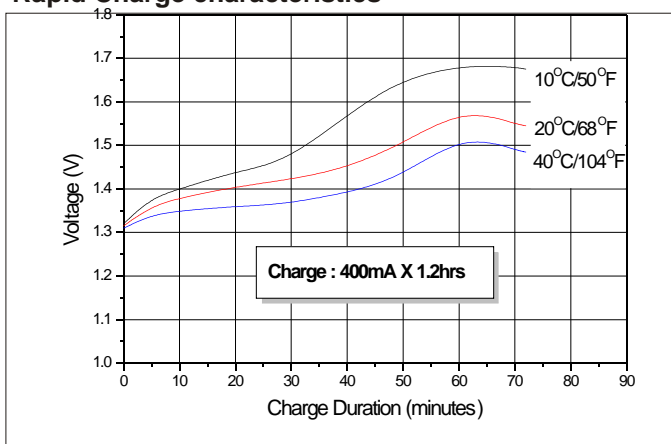

#### Standard Charge characteristics

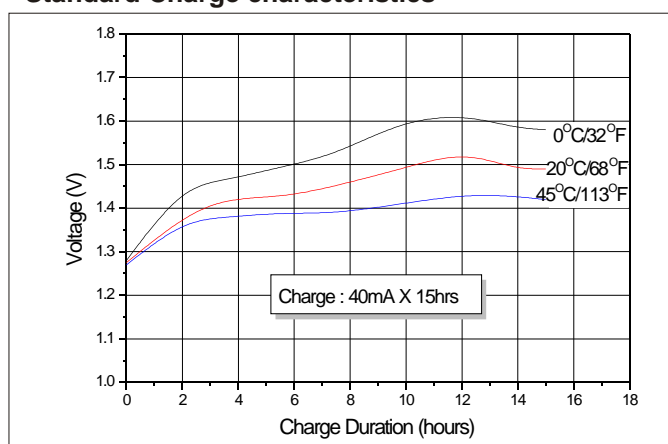

#### Discharge characteristics at various rate

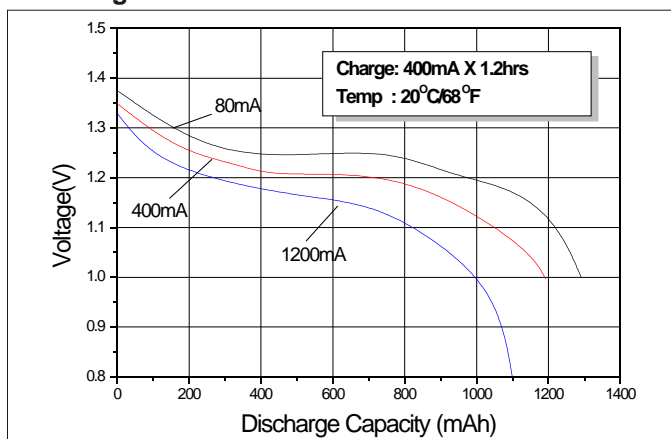

Note:

1. After charging at 0.1C for 15hours
2. Nominal capacity, rated at 0.2C, 20°C
3. Average capacity, For reference only
4. Weight and internal impedance are for reference.